

# DBHYD SPARE PARTS LIST

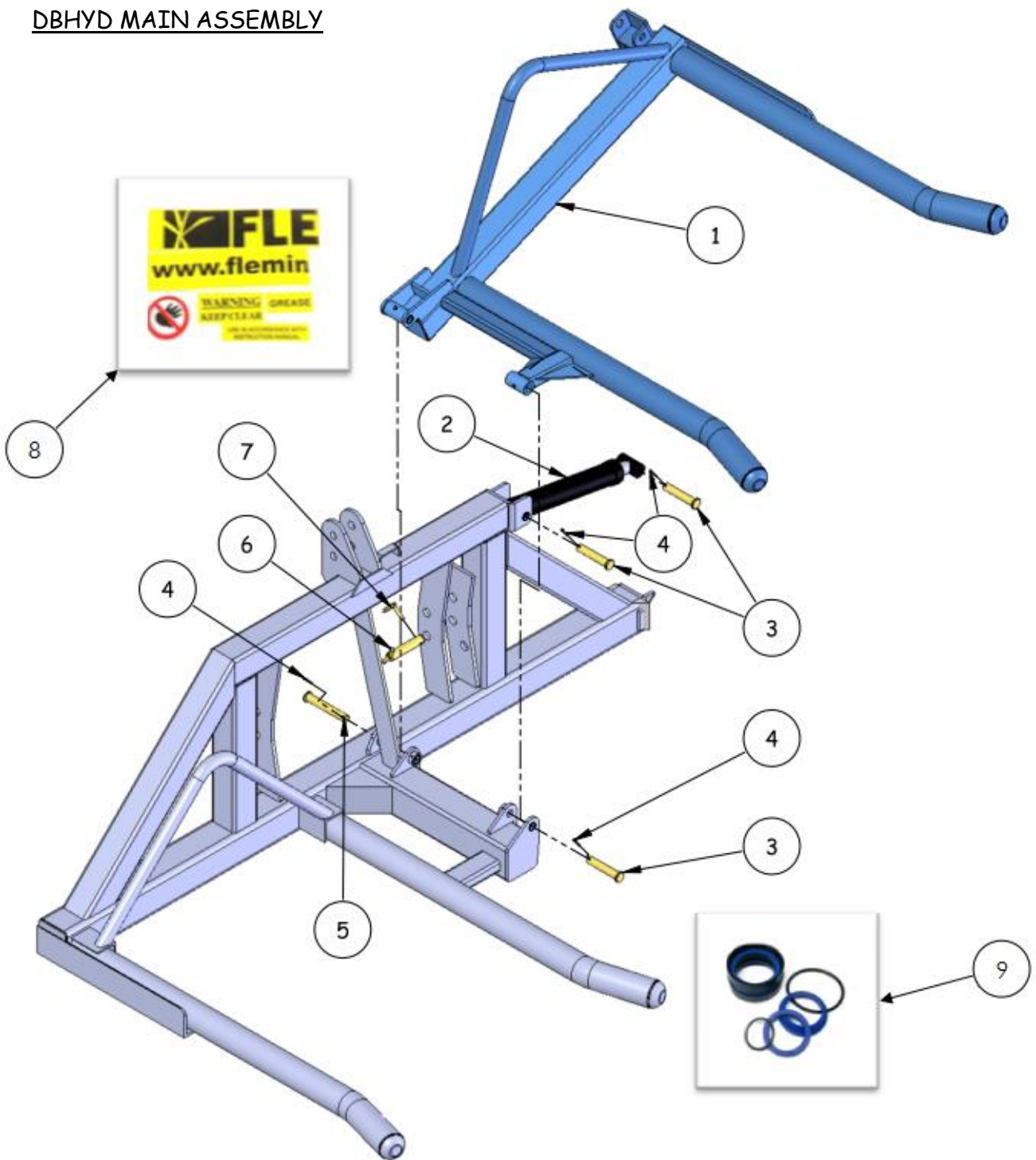

DBHYD MAIN ASSEMBLY



SEE TABLE NO: 001

TABLE NO: 001 HYDRAULIC DOUBLE BALE LIFTER MAIN ASSEMBLY			
ITEM NO	DESCRIPTION	DBHYD	
		CODE	QTY
1	DBHYD OUTER BALE CARRIER	P001.255	1
2	HYDRAULIC RAM	ZGPP33	1
3	RAM PIN (25DIA x 130mm)	ZGPP95	3
4	M6 x 40 ROLL PIN	ZFAS30	4
5	RAM PIN (25DIA x 165mm)	ZGPP96	1
6	CAT2 LIFT ARM PIN	ZGPP62	2
7	M10X40 LINCH PIN	ZFAS31	2
8	SAFETY STICKER KIT	P001.506	1
9	HYDRAULIC RAM SEAL KIT	HYDSK6	1
	HYDRAULIC HOSE	ZHYD02	1
	HYDRAULIC HOSE	ZGPP61	1

DBHYD FIXED BALE CARRIER ASSEMBLY

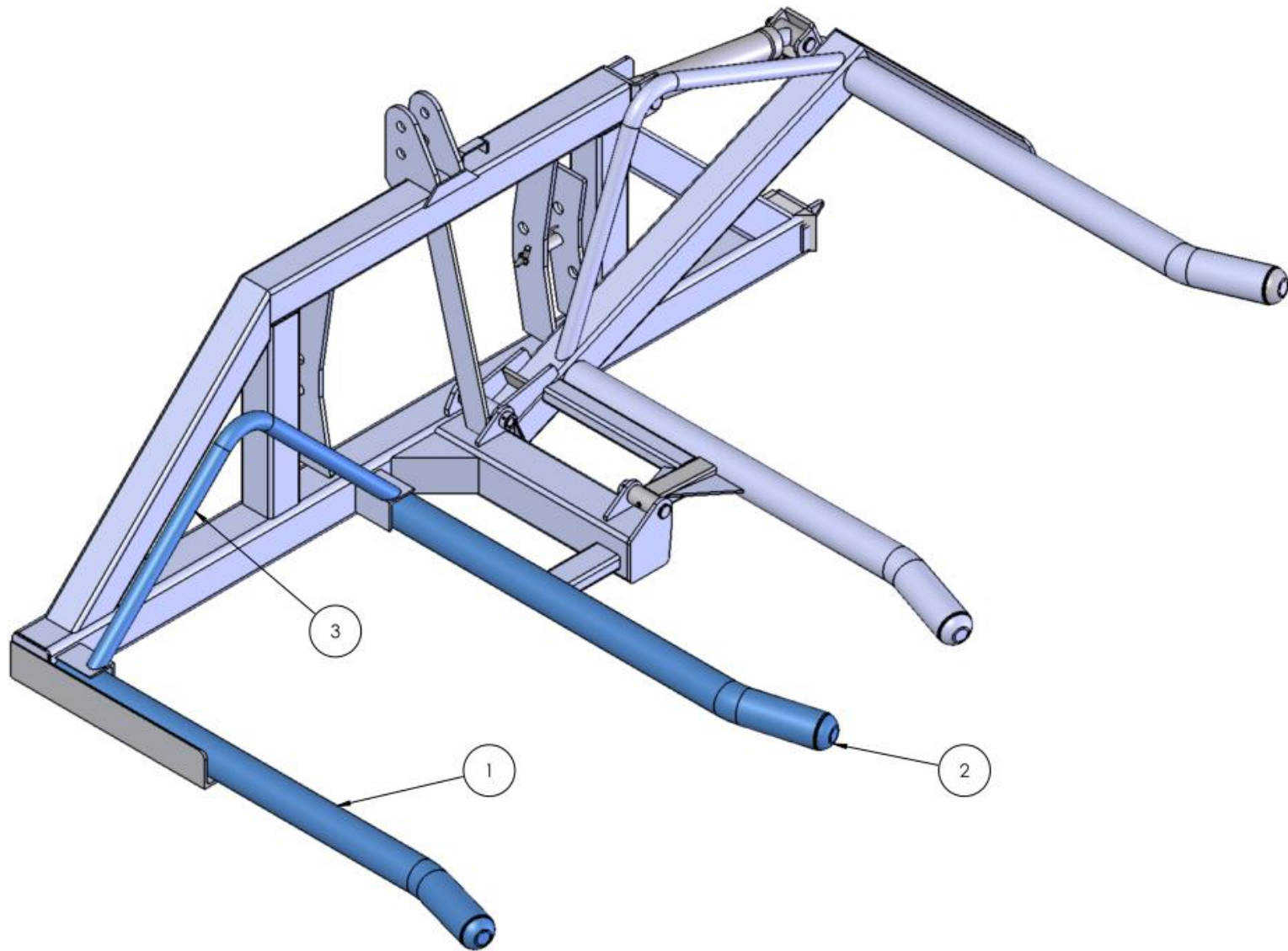

SEE TABLE NO: 002

TABLE NO: 002 DBHYD FIXED BALE CARRIER ASSEMBLY			
ITEM NO	DESCRIPTION	DBHYD	
		CODE	QTY
1	DBHYD BALE LIFTER ARM	P001.256	2
2	DOMED END	P001.233	2
3	DBHYD BALE GUARD	P001.257	1

DBHYD OUTER BALE CARRIER ASSEMBLY

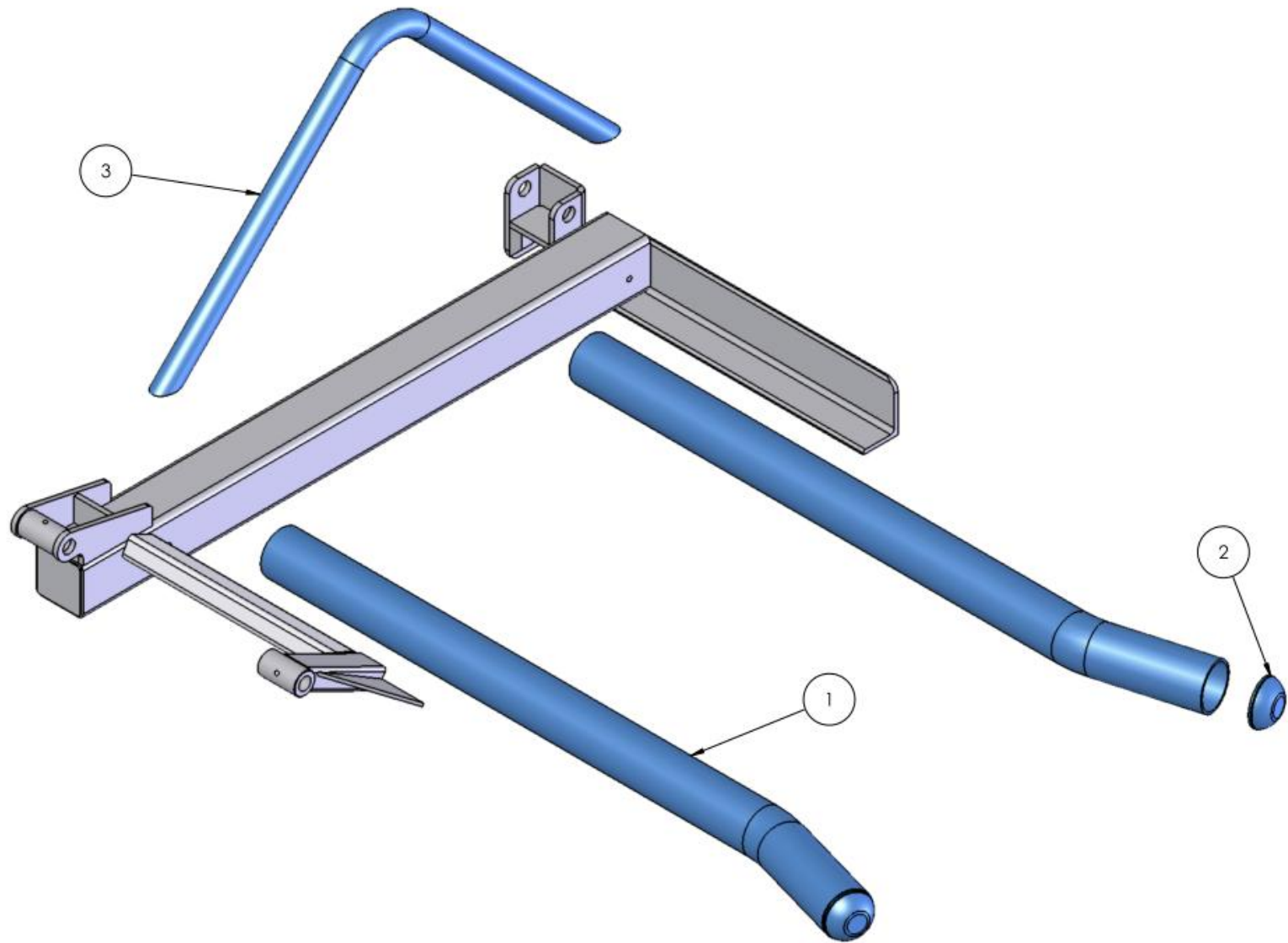

SEE TABLE NO: 003

**TABLE NO: 003 DBHYD OUTER BALE CARRIER ASSEMBLY**

ITEM NO	DESCRIPTION	DBHYD	
		CODE	QTY
1	DBHYD BALE LIFTER ARM	P001.256	2
2	DOMED END	P001.233	2
3	DBHYD BALE GUARD	P001.257	1