

# COMPACT LANDROLLER SPARE PARTS LIST

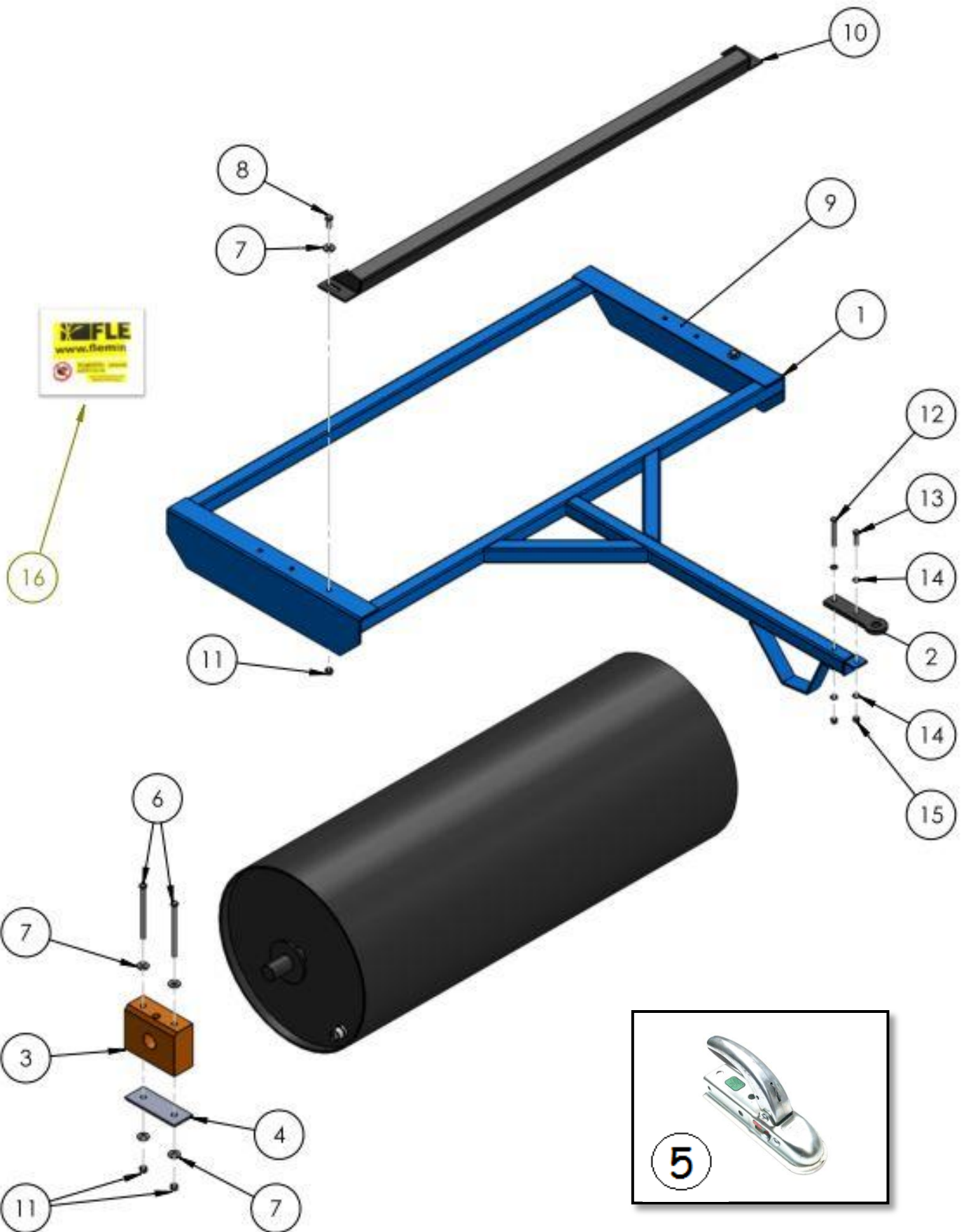

**Table of Contents:**

**COMPACT LANDROLLER SPARE PARTS LIST**

Table 001 : 4ft & 5ft COMPACT ROLLER MAIN ASSEMBLY	Page 2.
Table 002: 4ft & 5ft COMPACT ROLLER BARRELL ASSEMBLY	Page 4.
Table 003: 6ft & 8ft COMPACT ROLLER MAIN ASSEMBLY	Page 6.
Table 004: 6ft & 8ft COMPACT ROLLER BARRELL ASSEMBLY	Page 8.
Table 005: 6ft & 8ft COMPACT ROLLER SCRAPER ASSEMBLY	Page 10.

4ft & 5ft LANDROLLER MAIN ASSEMBLY



SEE TABLE NO: 001

**TABLE NO: 001 4ft & 5ft LANDROLLER MAIN ASSEMBLY**

ITEM NO	DESCRIPTION	4246		5246	
		CODE	QTY	CODE	QTY
1	MAIN FRAME	P001.079	1	P001.082	1
2	TOWING EYE	ZPPA132	1	ZPPA132	1
3	LANDROLLER BEARING	ZGPP51	2	ZGPP51	2
4	BEARING PLATE	ZGPP101	2	ZGPP101	2
5	FEMALE BALL HITCH (REPLACEMENT FOR ITEM 2)	ZGPP92	1	ZGPP92	1
6	BOLT	ZFAS16	4	ZFAS16	4
7	WASHER ZP	ZFAS45	4	ZFAS45	4
8	M12X30 SETSCREW ZP	ZFAS10	2	ZFAS10	2
9	GREASE NIPPLE	ZGPP31	2	ZGPP31	4
10	SCRAPER BLADE	4SB	1	5SB	1
11	M12 NYLOCK NUT	ZFAS22	6	ZFAS22	6
12	M10x90 BOLT	ZFAS128	1	ZFAS128	1
13	M10x40 SETSCREW	ZFAS105	1	ZFAS105	1
14	M10 WASHER ZP	ZFAS03	4	ZFAS03	4
15	M10 NYLOCK	ZFAS20	2	ZFAS20	2
16	STICKER KIT	P001.527	1	P001.527	1

4ft & 5ft LANDROLLER BARRELL ASSEMBLY

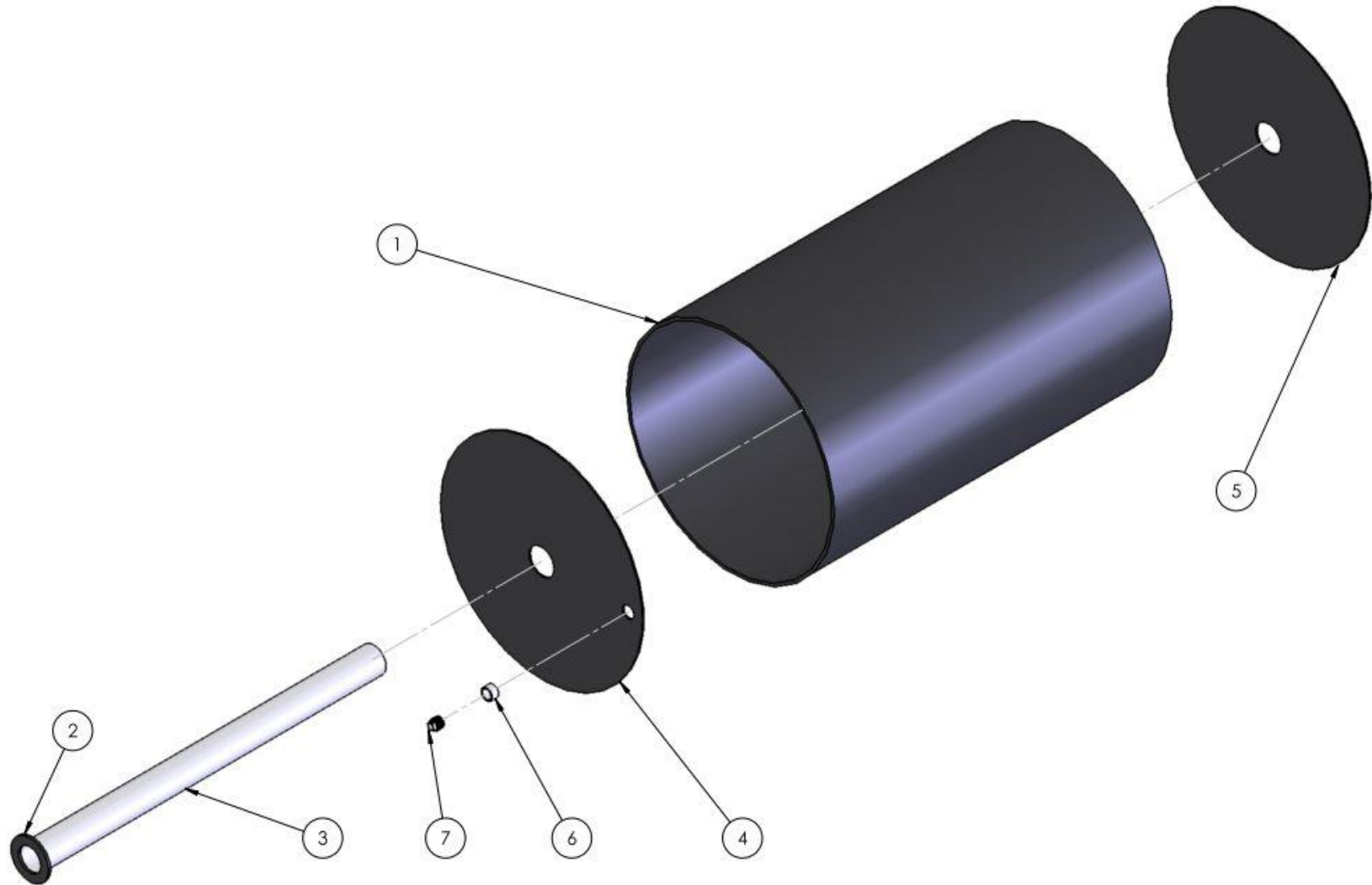

SEE TABLE NO: 002

**TABLE NO: 002 4ft & 5ft LANDROLLER BARRELL ASSEMBLY**

ITEM NO	DESCRIPTION	4246		5246	
		CODE	QTY	CODE	QTY
1	COMPLETE BARRELL (ALL ITEMS)	P001.081	1	P001.084	1
2	END WASHER	ZPPA19	2	ZPPA19	2
3	CENTRE SHAFT	P001.080	1	P001.083	1
4	END DISC C/W DRAIN HOLE	ZPPA14A	1	ZPPA14A	1
5	END DISC	ZPPA14	1	ZPPA14	1
6	1" SOCKET	ZFAS33	1	ZFAS33	1
7	1" BUNG	ZFAS32	1	ZFAS32	1

6ft & 8ft COMPACT LANDROLLER MAIN ASSEMBLY

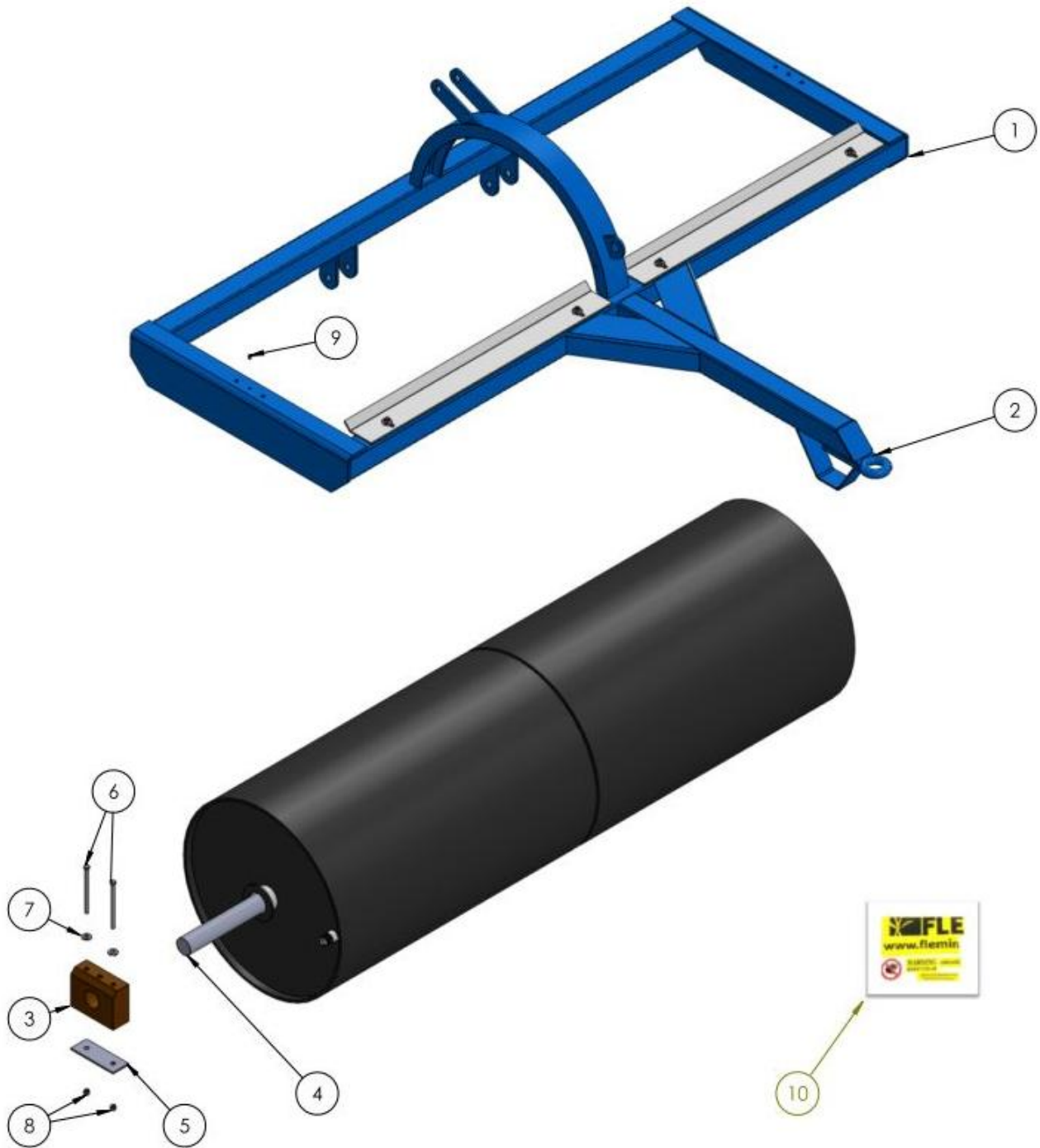

SEE TABLE NO: 003

**TABLE NO: 003 6ft& 8ft COMPACT LANDROLLER MAIN ASSEMBLY**

ITEM NO	DESCRIPTION	6246		8246	
		CODE	QTY	CODE	QTY
1	MAIN FRAME	P001.085	1	P001.089	1
2	TOWING EYE	ZGPP14	1	ZGPP14	1
3	LANDROLLER BEARING	ZGPP51	2	ZGPP51	2
4	CENTRE SHAFT	P001.086	1	P001.090	1
5	BEARING PLATE	ZGPP101	2	ZGPP101	2
6	BOLT	ZFAS16	4	ZFAS16	4
7	WASHER ZP	ZFAS45	4	ZFAS45	4
8	NYLOCK NUT	ZFAS22	4	ZFAS22	4
9	GREASE NIPPLE	ZGPP31	2	ZGPP31	4
10	STICKER KIT	P001.528	1	P001.528	1



6ft & 8ft COMPACT ROLLER DRUM ASSEMBLY

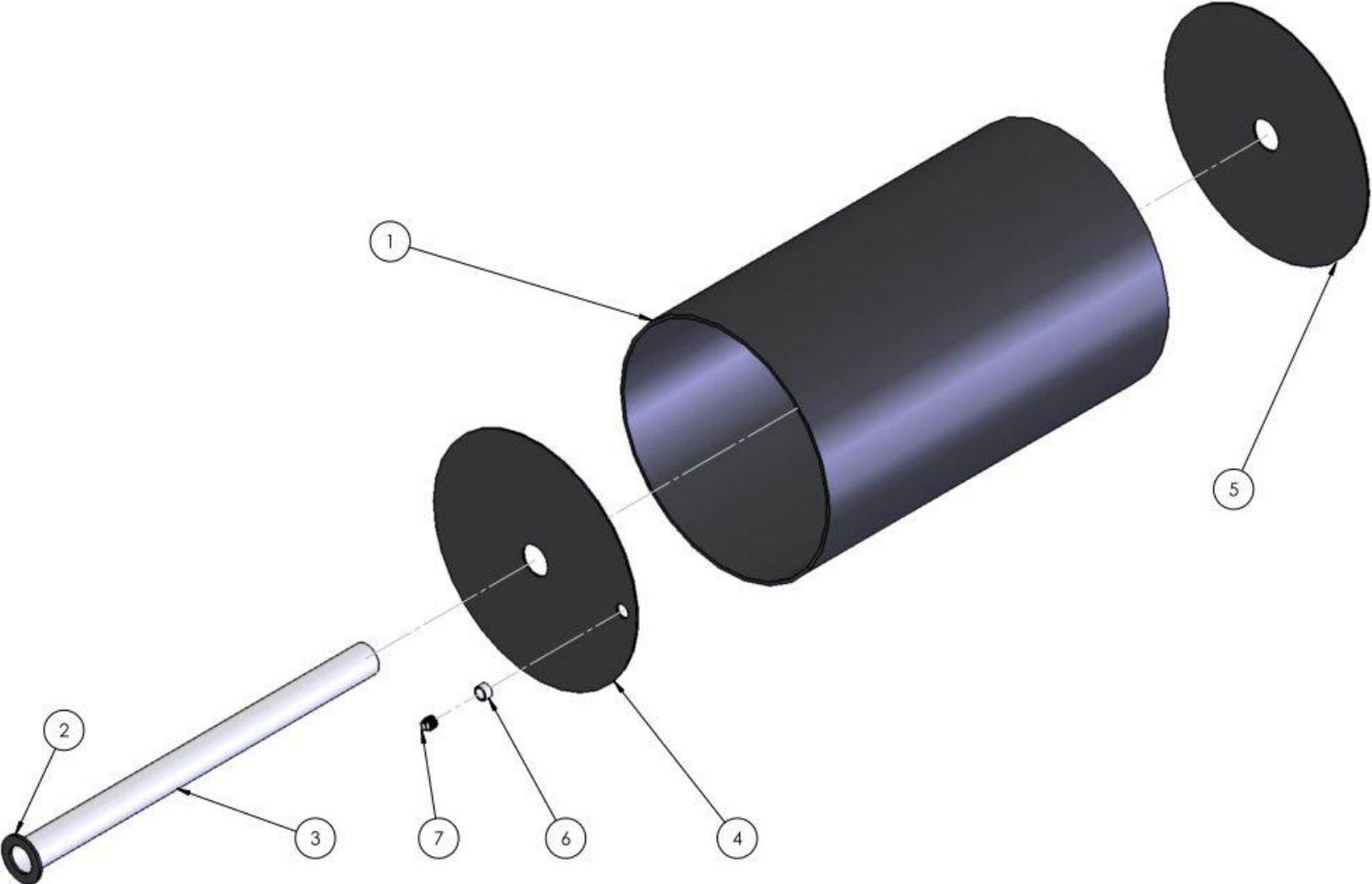

SEE TABLE NO: 004

**TABLE NO: 004 6ft & 8ft COMPACT LANDROLLER BARRELL ASSEMBLY**

ITEM NO	DESCRIPTION	6246		8246	
		CODE	QTY	CODE	QTY
1	COMPLETE BARRELL (ALL ITEMS)	P001.087	1	P001.091	1
2	END WASHER	ZPPA19	2	ZPPA19	2
3	CENTRE PIPE	P001.088	1	P001.092	1
4	END DISC C/W DRAIN HOLE	ZPPA23A	1	ZPPA284A	1
5	END DISC	ZPPA23	1	ZPPA284	1
6	1" SOCKET	ZFAS33	1	ZFAS33	1
7	1" BUNG	ZFAS32	1	ZFAS32	1

6ft & 8ft COMPACT LANDROLLER SCRAPER ASSEMBLY

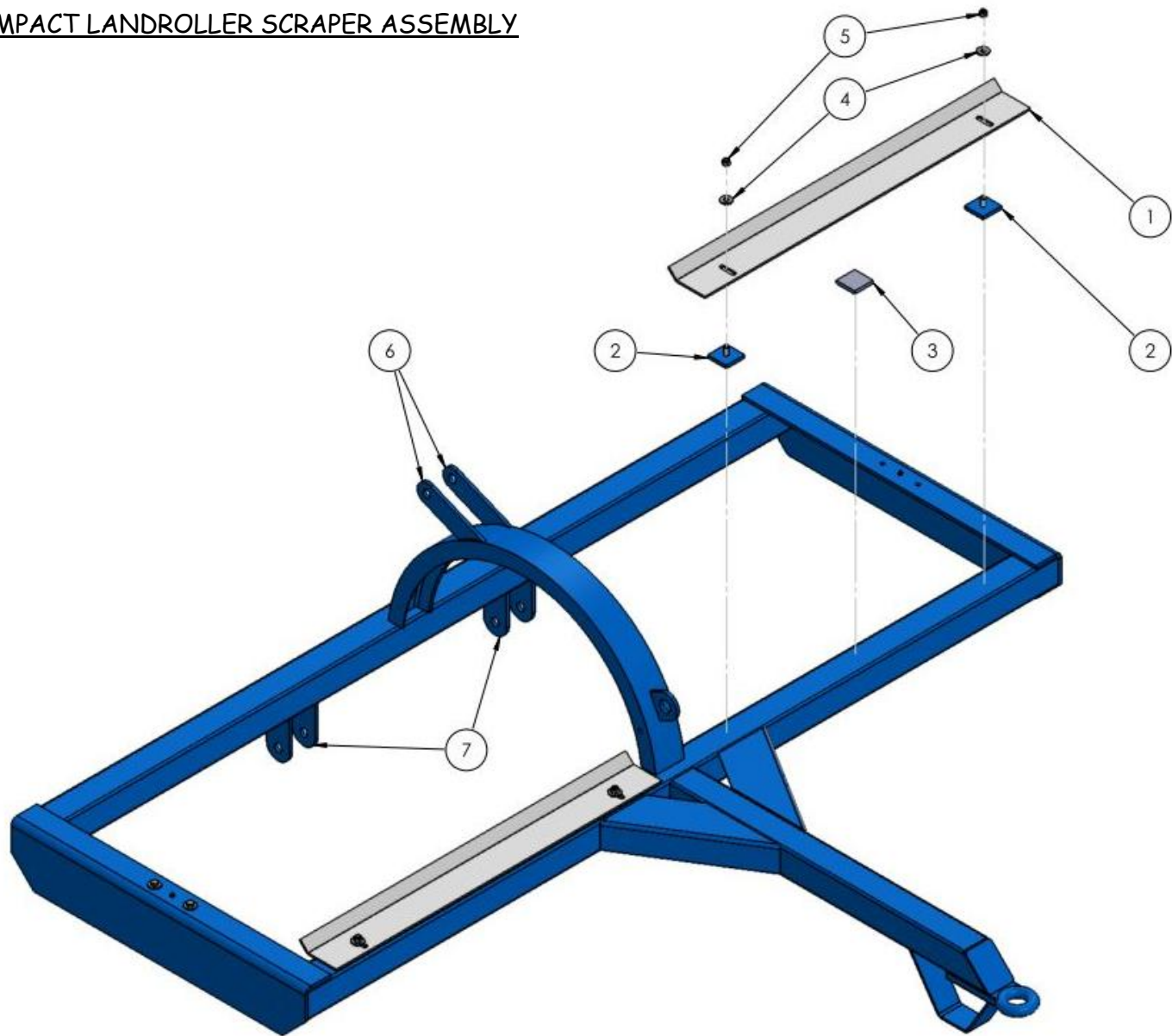

SEE TABLE NO: 005

**TABLE NO: 005 6ft & 8ft COMPACT LANDROLLER SCRAPER ASSEMBLY**

ITEM NO	DESCRIPTION	103612		103016	
		CODE	QTY	CODE	QTY
1	SCRAPER KIT (EXCLUDES ITEMS 2&3)	6SB	1	8246SB	1
2	LOCATOR BRACKET (WELD ON)	P001.098	4	P001.098	4
3	SPACER BRACKET (WELD ON)	P001.099	2	P001.099	2
4	WASHER ZP	ZFAS45	4	ZFAS45	4
5	NYLOCK NUT	ZFAS22	4	ZFAS22	4
	COMPLETE BRACKET KIT (2 & 3)	P001.100	1	P001.100	1
6	TOPLINK BRACKET	ZPPA65	2	ZPPA65	2
7	LIFT ARM BRACKET	ZPPA133	4	ZPPA133	4